

## Bottom View

Figure-construct-1  
Copyright 2008  
Vanderveen

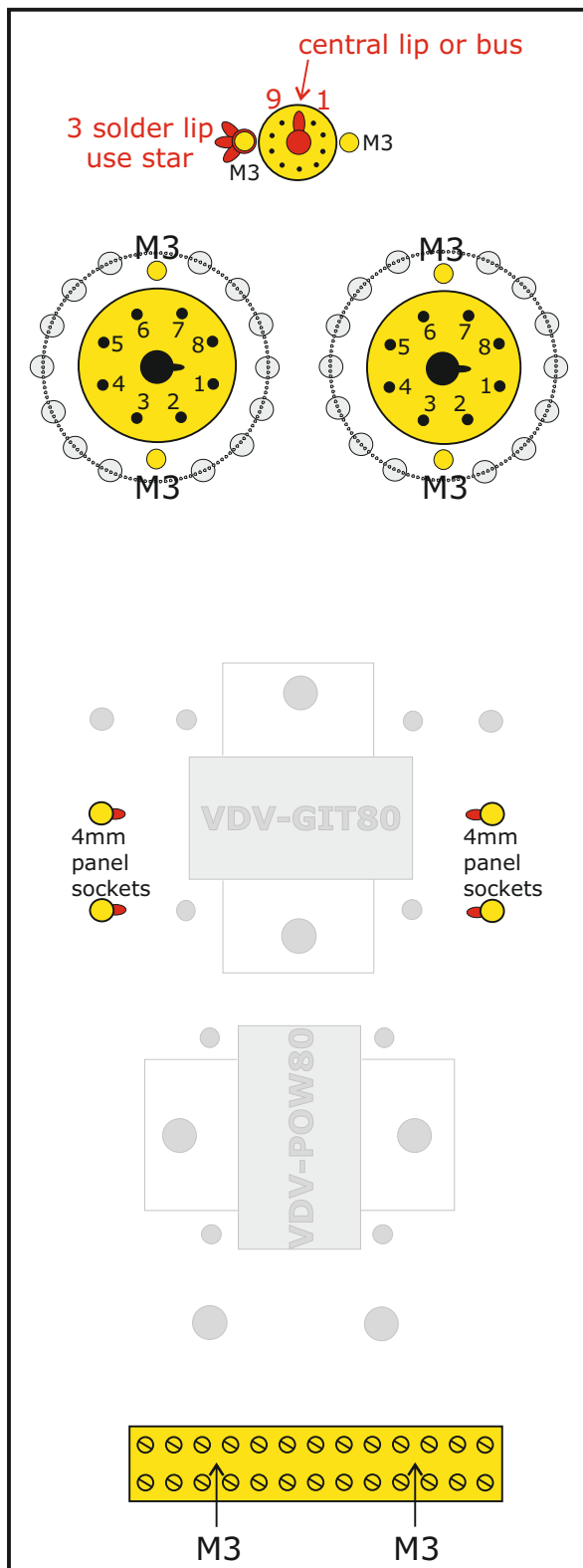

## Bottom View

Figure-construct-2  
Copyright 2008  
Vanderveen

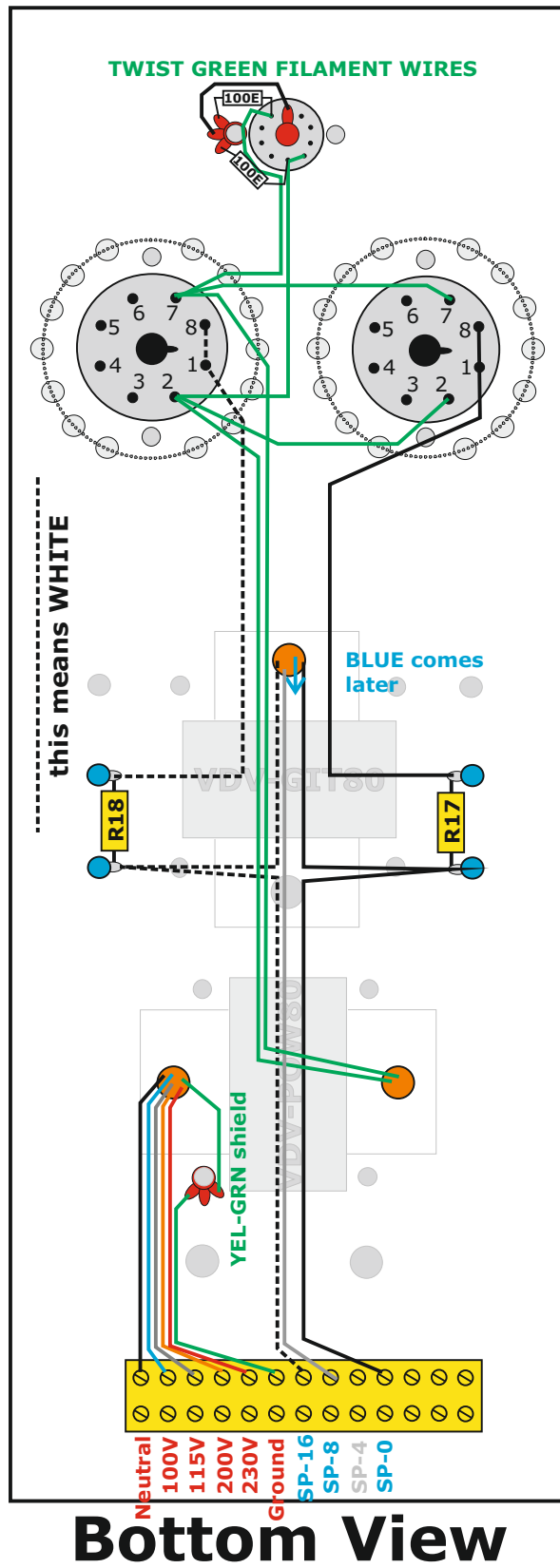
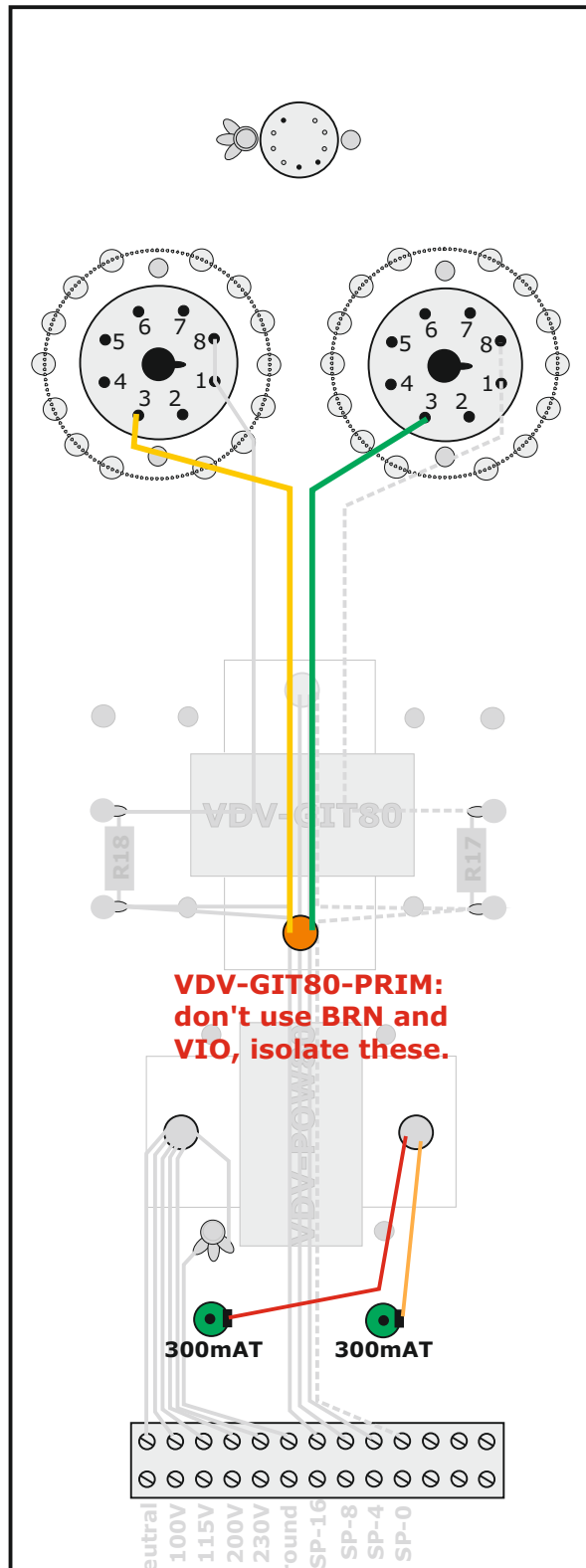
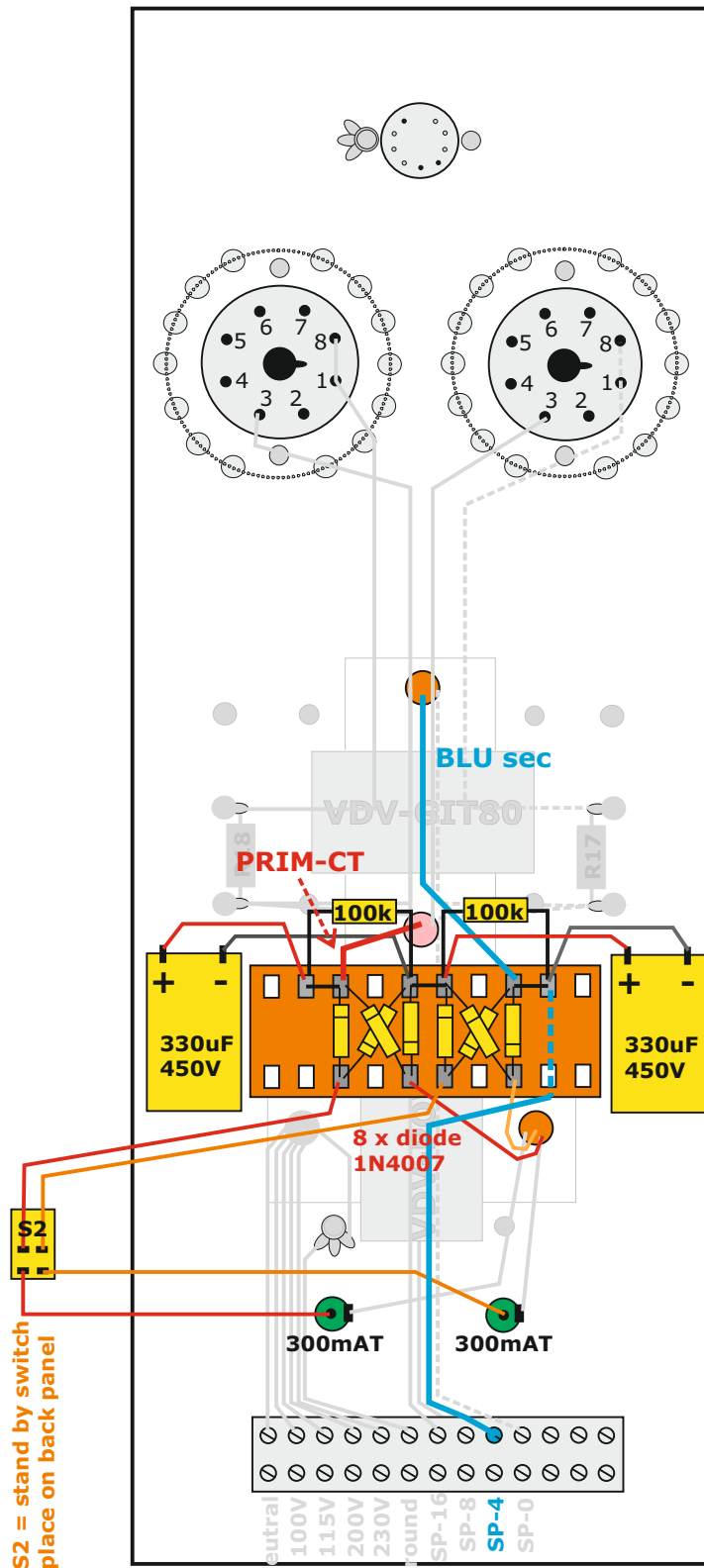

Figure-construct-3  
Copyright 2008  
Vanderveen



**Bottom View**

Figure-construct-4  
Copyright 2008  
Vanderveen



**Bottom View**

Figure-construct-5  
Copyright 2008  
Vanderveen

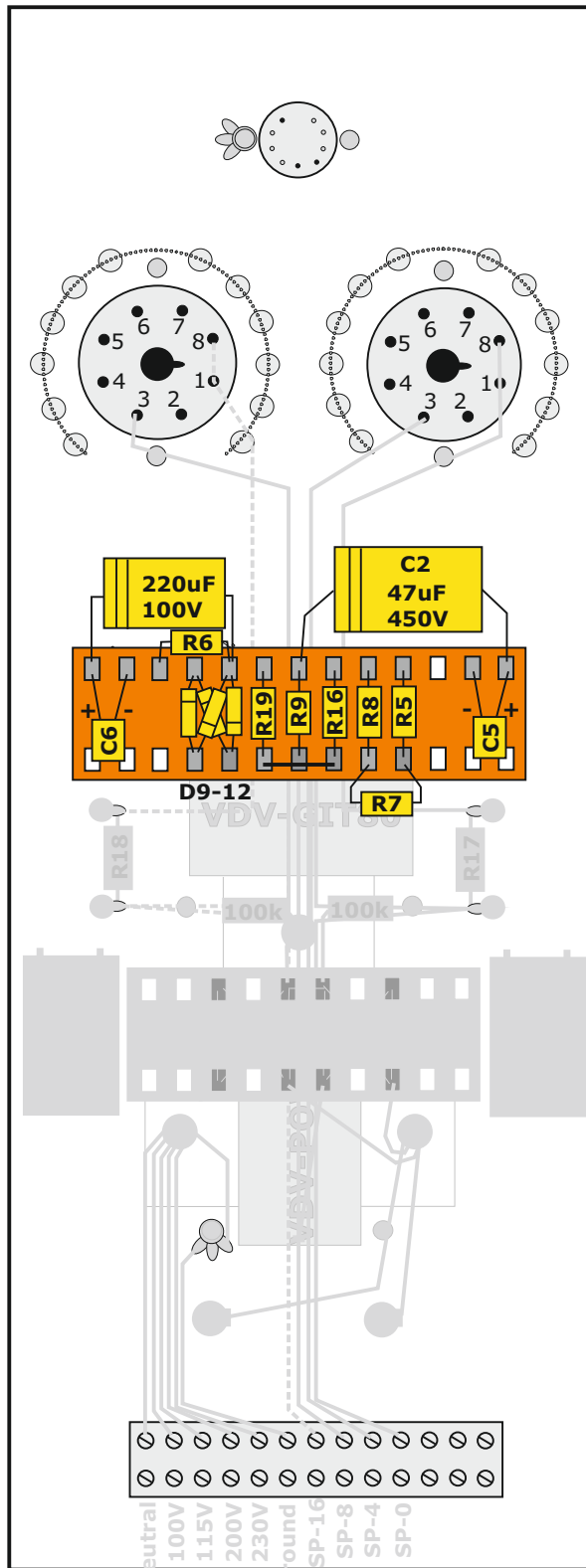

**Bottom View**

Figure-construct-6  
Copyright 2008  
Vanderveen

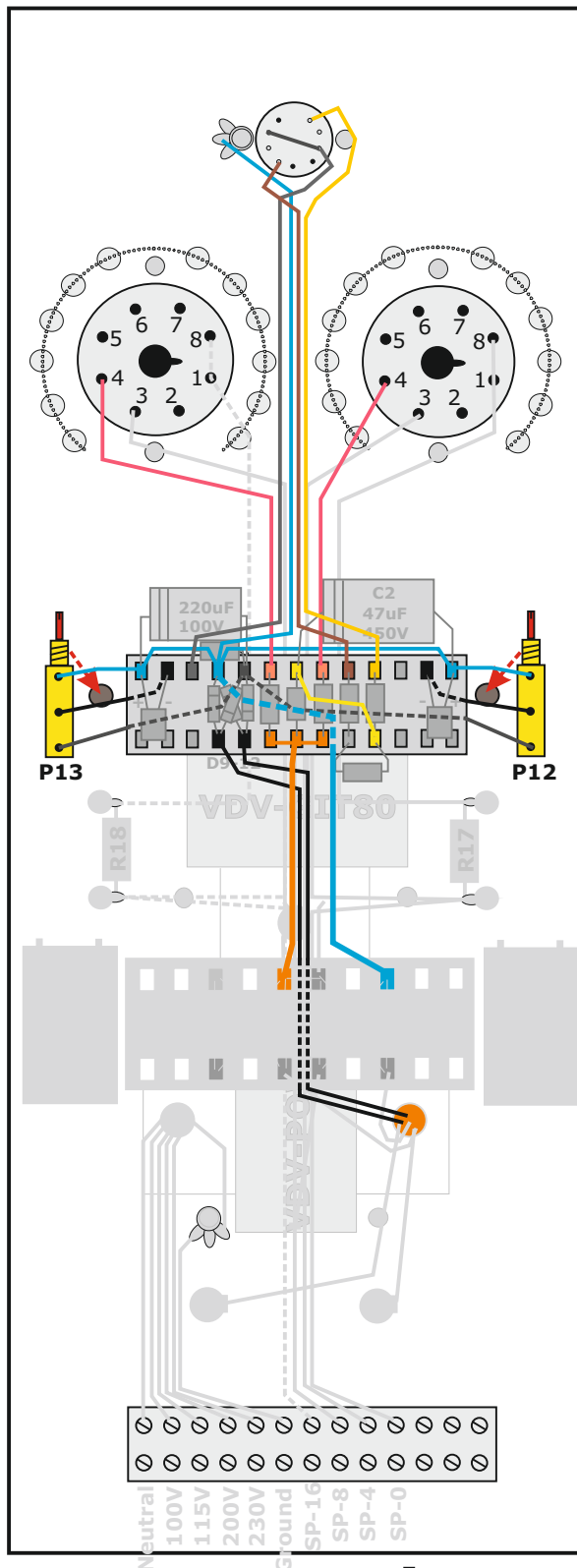

**Bottom View**

Figure-construct-7  
Copyright 2008  
Vanderveen

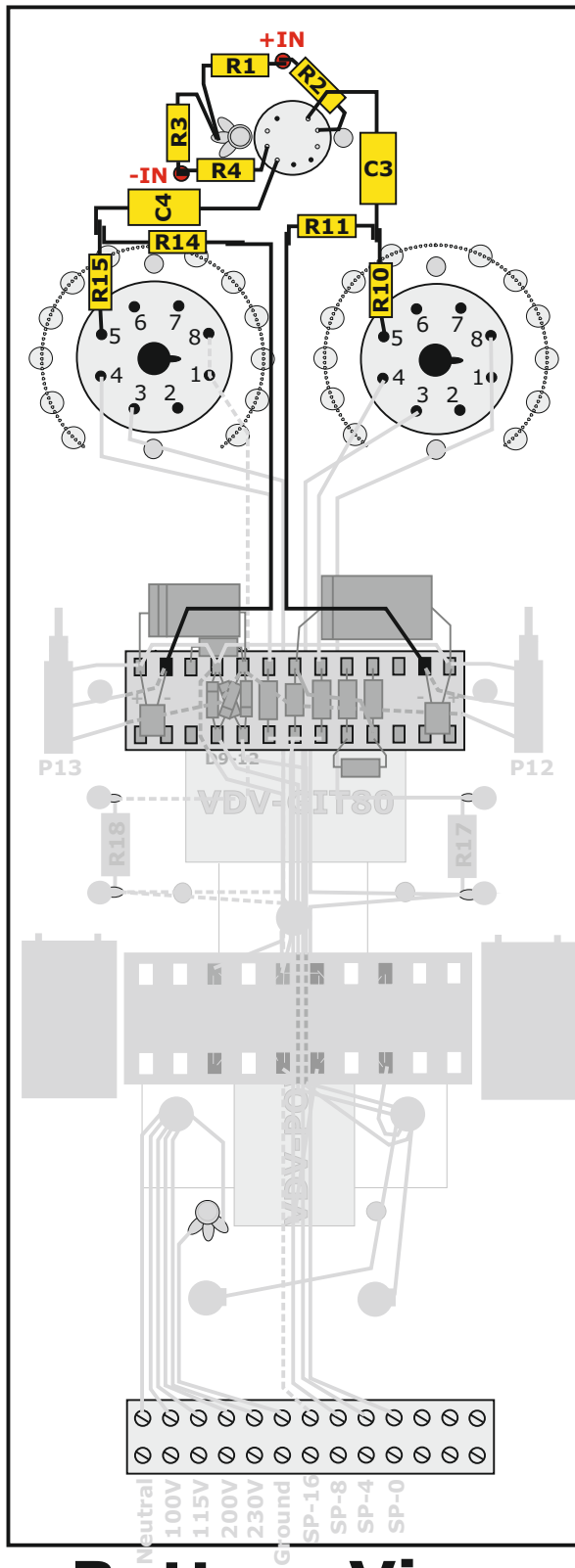

**Bottom View**

Figure-construct-8  
Copyright 2008  
Vanderveen



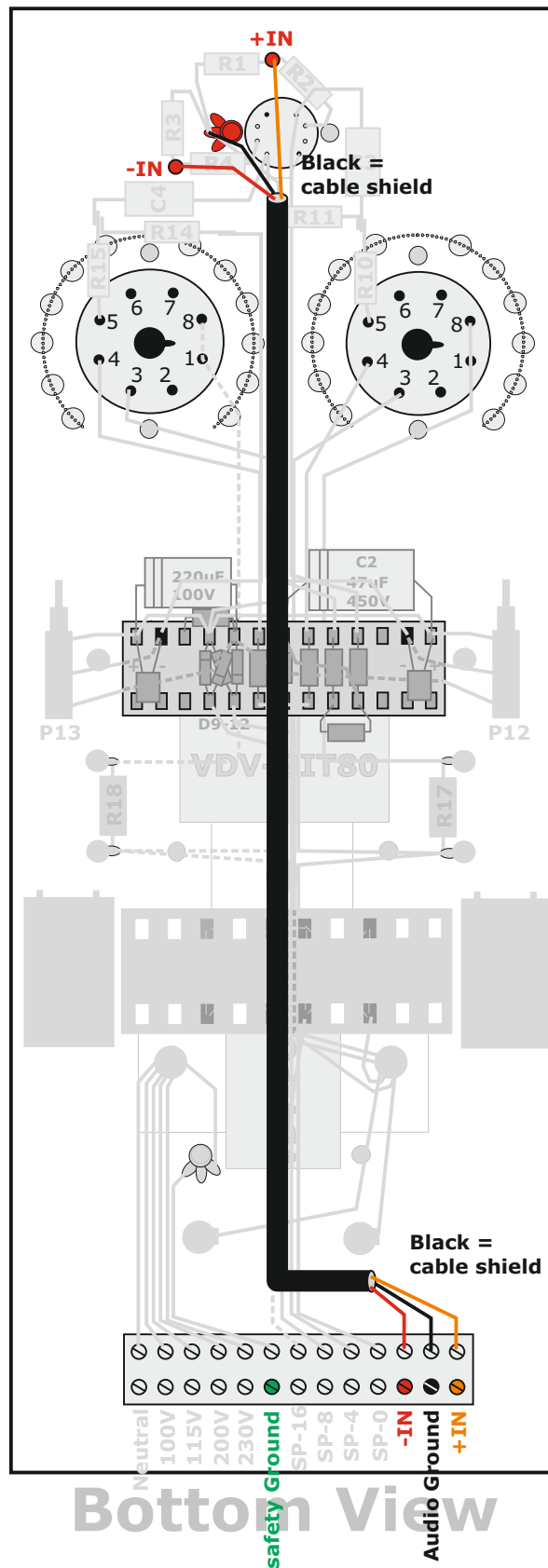
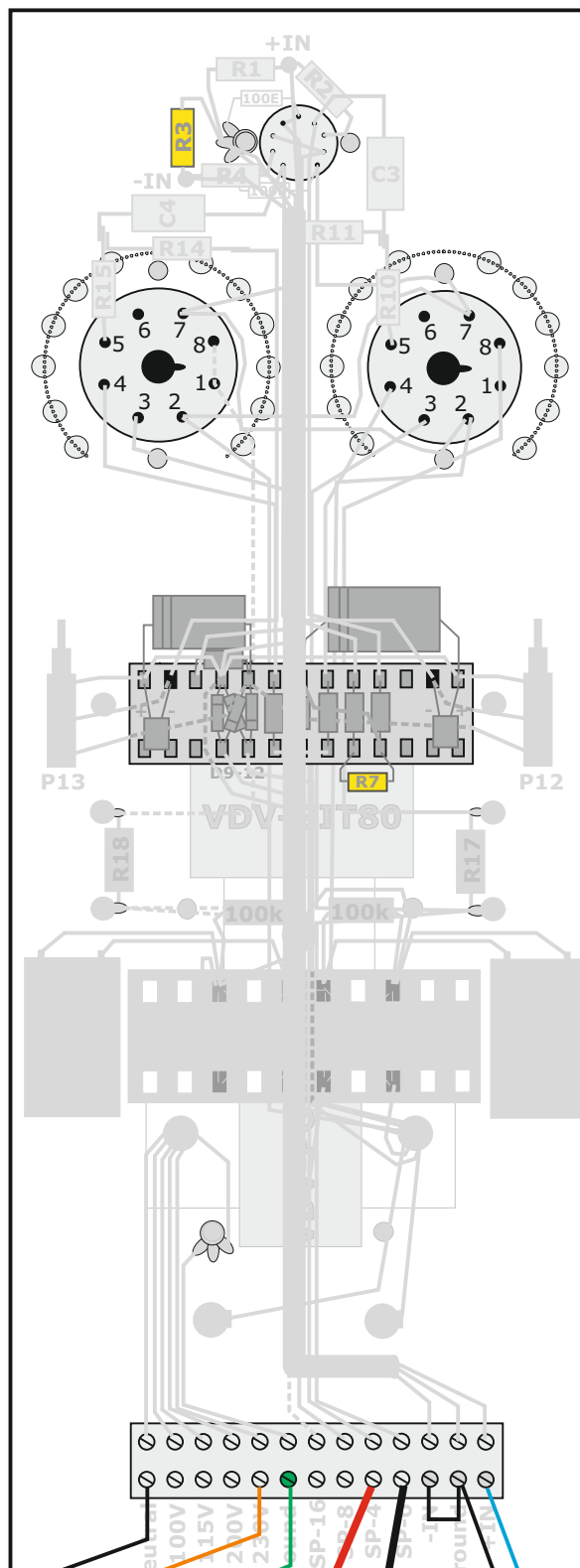

Figure-construct-9  
Copyright 2008  
Vanderveen



IEC-chassis  
with fuse 1,5E2



S1

on/off

Speaker Terminals  
wired for 4 Ohms



RCA-input



a-symmetrical  
R3 = 0 = shortcut  
R7 = 22k

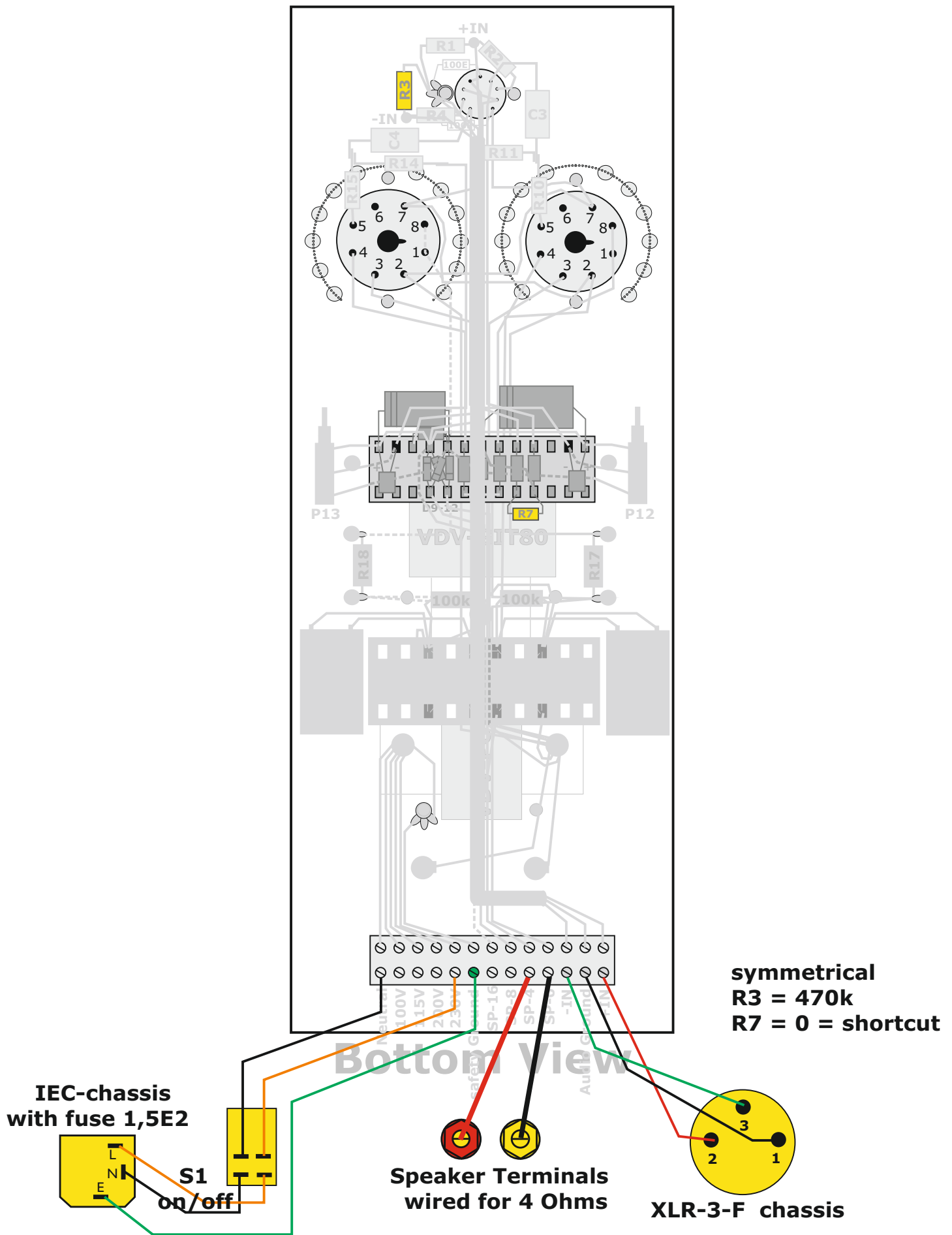

Figure-construct-11  
 Copyright 2008  
 Vanderveen